

ELENCO KIT - KIT LIST			
CODICE	Q.TA'	DESCRIZIONE	DESCRIPTION
00300100	1	KIT GUARNIZIONI CILINDRO 110/70	CYLINDER GUARNITION 110/70
6330006	02	KIT ATTACCO TELAI	CHASSIS KIT
6330009	02	KIT PERNO FUSO	PIN KIT
8360002	02	KIT MOZZO	HUB KIT
8450007	01	KIT CILINDRO	CYLINDER KIT
8450008	01	KIT CORPO	BODY KIT
8450009	02	KIT FUSO	STEERING KNUCKLE KIT
8450010	02	KIT BIELLA	LINK KIT

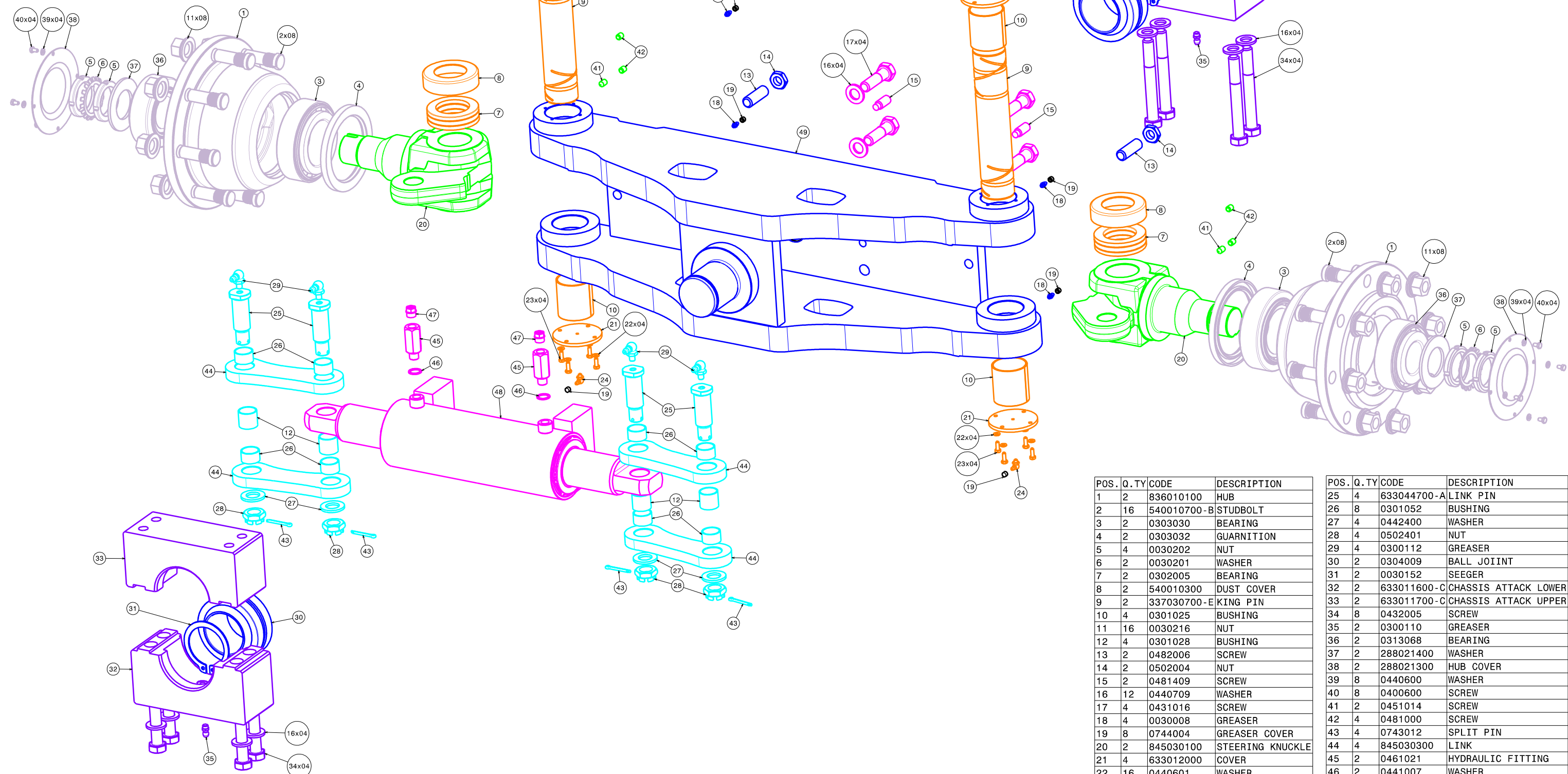

POS.	Q. TY	CODE	DESCRIPTION
1	2	836010100	HUB
2	16	540010700-B	STUDBOLT
3	2	0303030	BEARING
4	2	0303032	GUARNITION
5	4	0030202	NUT
6	2	0030201	WASHER
7	2	0302005	BEARING
8	2	540010300	DUST COVER
9	2	337030700-E	KING PIN
10	4	0301025	BUSHING
11	16	0030216	NUT
12	4	0301028	BUSHING
13	2	0482006	SCREW
14	2	0502004	NUT
15	2	0481409	SCREW
16	12	0440709	WASHER
17	4	0431016	SCREW
18	4	0030008	GREASER
19	8	0744004	GREASER COVER
20	2	845030100	STEERING KNUCKLE
21	4	633012000	COVER
22	16	0440601	WASHER
23	16	0430602	SCREW
24	4	0030065	GREASER

POS.	Q. TY	CODE	DESCRIPTION
25	4	633044700-A	LINK PIN
26	8	0301052	BUSHING
27	4	0442400	WASHER
28	4	0502401	NUT
29	4	0300112	GREASER
30	2	0304009	BALL JOINT
31	2	0030152	SEEGER
32	2	633011600-C	CHASSIS ATTACK LOWER
33	2	633011700-C	CHASSIS ATTACK UPPER
34	8	0432005	SCREW
35	2	0300110	GREASER
36	2	0313068	BEARING
37	2	288021400	WASHER
38	2	288021300	HUB COVER
39	8	0440600	WASHER
40	8	0400600	SCREW
41	2	0451014	SCREW
42	4	0481000	SCREW
43	4	0743012	SPLIT PIN
44	4	845030300	LINK
45	2	0461021	HYDRAULIC FITTING
46	2	0441007	WASHER
47	2	0744015	HYDRAULIC TAP
48	1	0030894	CYLINDER
49	1	845030500	BODY

CYLINDER FEATURES
 BORE : 110mm
 ROD : 70 mm
 TOTAL STROKE : 203 mm
 OIL VOLUME : 1148 cc

THEORICAL WHEELBASE : 2731 mm
MAX LOAD ON THE AXLE : 15 TON @ 25 km/h

BORGHI S.R.L.
 ASSALE 4R 15 T - PASSO 2800mm
 3. PRELIEVO ELETTORE ANTERIORE ALLA "BORSA" S.R.L.
 PER IL RIFERIMENTO DEL MANUALE
 PER IL RIFERIMENTO DEL MANUALE
 AFFIDABILITÀ SOSTA
 4:11
 S.D. 27.11.14
 845030000